

# S-5!®

The Right Way!

SnoClip™

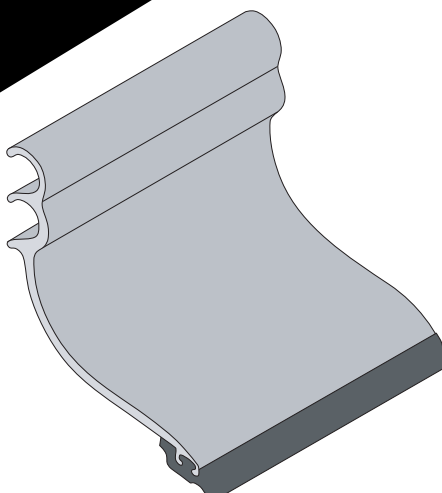

**SnoClip II™**

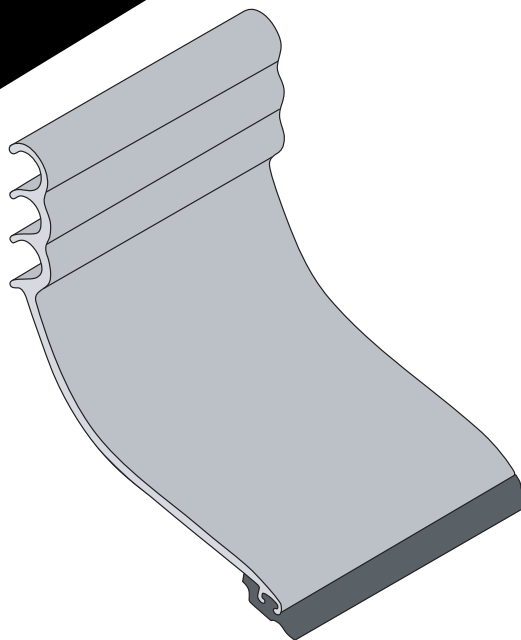

**SnoClip III™**

## SnoClip™

This aluminum component retards the migration of snow and ice beneath the ColorGard® crossmember or SnoFence/SnoRail SnoRod™. It has a special integrated rubber “foot” to prevent abrasion of the panel’s finish. SnoClip snaps to the back of the crossmember or rod and extends down to the flat of the roofing panel.

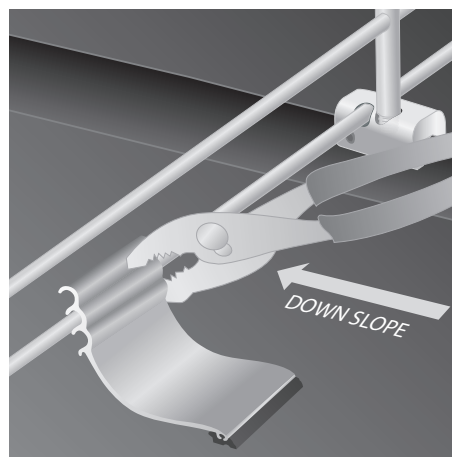
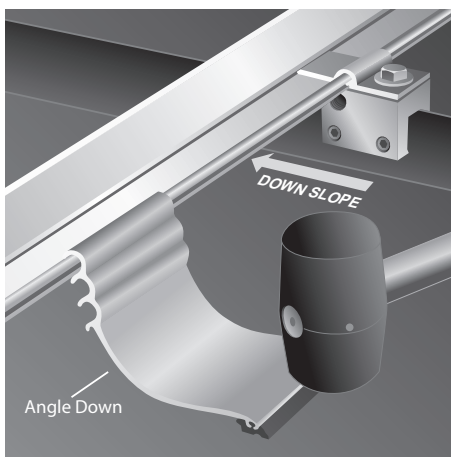
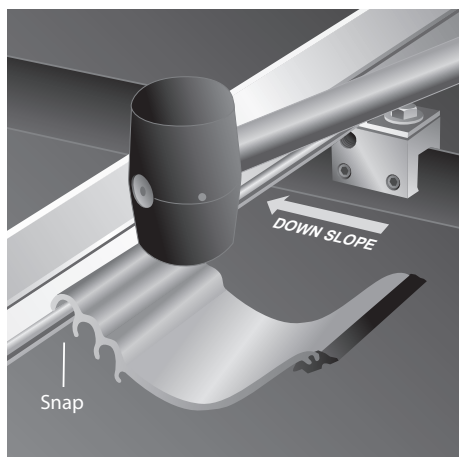

Attach almost **anything** to standing seam metal roofs  
without piercing the panel!

888-825-3432

[www.S-5.com](http://www.S-5.com)

## SnoClip™

### Using SnoClip

SnoClip II™ or SnoClip III™ can be added to the assembly using a mallet, pliers, or Channel-Locks. One clip is used between seams (in rare cases two clips may be desired, see website for details). Mount the SnoClip to the back of the cross member or rod (on SnoFence™ only use on lower rod, never use on top rod) using the lock that results with the rubber “foot” resting properly on the panel surface. When applying downward pressure on the part, the “toe” should engage the surface of the panel just before the “heel.” Periodic maintenance over time may be necessary to ensure that the SnoClips maintain the appropriate positioning, as snow weight may sometimes flip the clip up slightly.

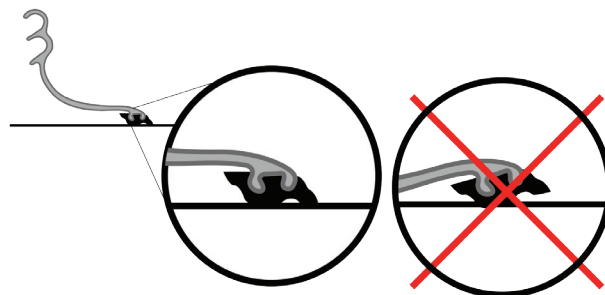

### SnoClip II

SnoClip II has 2 locks and is especially made for seam heights of 1" (25 mm) and 1-3/4" (44.5 mm) snap. It will also fit 2" (51 mm) vertical seams, but not 2" (51 mm) horizontal.

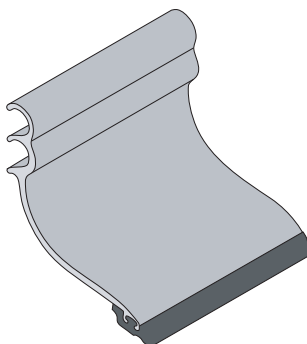

### SnoClip III

SnoClip III has 3 different locks and will work on seam heights of 1-3/4" (44.5mm) up to 3" (76 mm).

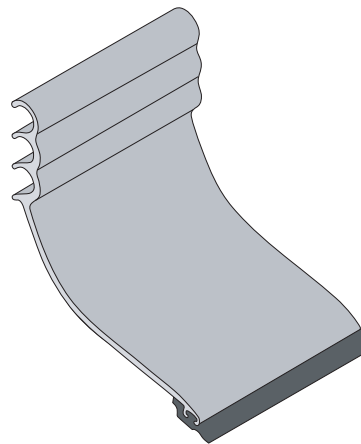

**Notes:** Do not use with attachment spacing greater than 32" (81.3 cm). Custom SnoClips are available for seam spacing greater than 32" (81.3 cm). Please inquire through a distributor. SnoClip should not be used with Brass SnoFence/SnoRail™ on copper roofs.

S-5! Warning! Please use this product responsibly!

*Products are protected by multiple U.S. and foreign patents. Visit the website at [www.S-5.com](http://www.S-5.com) for complete information on patents and trademarks. For maximum holding strength, setscrews should be tensioned and re-tensioned as the seam material compresses. Clamp setscrew tension should be verified using a calibrated torque wrench between 160 and 180 inch pounds when used on 22ga steel, and between 130 and 150 inch pounds for all other metals and thinner gauges of steel. Consult the S-5! website at [www.S-5.com](http://www.S-5.com) for published data regarding holding strength.*

Copyright 2010, Metal Roof Innovations, Ltd. S-5! products are patented protected. S-5! aggressively protects its patents, trademarks and copyrights.

Distributed by